

# More timber structures for Haesley Nine Bridges

Yeosu-gun, KR



# More timber structures for Haesley Nine Bridges

Yeoju-gun, KR



## Project details

Client	CJ Group
Architecture	Shigeru Ban Architects
Project type	Leisure and sport, Hotels and restaurants, Office and administration
Construction type	Free Form, Wood element construction
Services	Timber construction
Construction	2018-2020
Locality	Yeoju
Country	South Korea

# More timber structures for Haesley Nine Bridges

Yeoju-gun, KR



---

## Even more spectacular timber structures at the Haesley Nine Bridges Golf Resort

After creating the eye-catching Club House, we built another six extraordinary structures for Haesley Nine Bridges Golf Club: a Learning Centre, a Recreation Centre, the Grand Hall underground foyer, a restaurant and the three Condo A apartment buildings. Our contract required us to plan all the timber construction work, produce the timber components and carry out the assembly process in South Korea. Shigeru Ban Architects came up with the idea and concept for all six additional structures at Haesley Nine Bridges Golf Resort.

You might call the view from the Grand Hall up to the lake with trees on the glass roof spectacular. From outside, 22 large potted plants decorate the construction. Sixteen stand in a 10 cm deep pool of water. In the underground hall, 22 Free Form timber columns support the glass roof's bearing structure.

The Learning Centre and the Recreation Centre are sensationally set apart by their sweeping roof shapes. The oval or wavy timber roofs, featuring an overhanging and sloped design, are each the crowning components of a pure steel structure and a reinforced concrete structure. The three apartment buildings offer accommodation for guests staying overnight at Haesley Golf Club. Six Free Form double-curved dormers set the tone for the style of each of the apartment buildings. Technically connecting the timber construction to the glass facades proved to be a particularly challenging part of the detailed planning process.

## Specific Contact



Daniel Bucher

Head of International Sales | Timber  
Construction | Free Form

T +41 71 388 52 51

[daniel.bucher@blumer-lehmann.com](mailto:daniel.bucher@blumer-lehmann.com)

# More timber structures for Haesley Nine Bridges

Yeosu-gun, KR



Haesley Nine Bridges Golf Club, Learning  
Centre at night



The distinctive timber beams on the ceiling  
create a pleasant atmosphere in the  
Recreation Centre's lounge.

# More timber structures for Haesley Nine Bridges



Yeosu-gun, KR



Simple, functional interior design in a classroom in the Learning Centre

Learning Centre auditorium

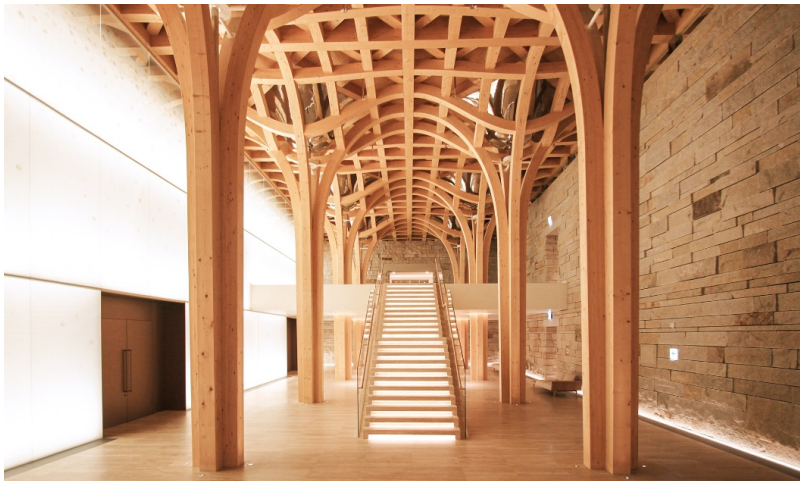

Stairs in the Learning Centre

# More timber structures for Haesley Nine Bridges



Yeosu-gun, KR



Dining hall with seating set out in the style of a concert hall

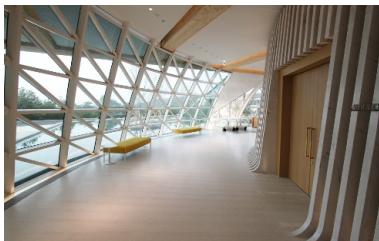
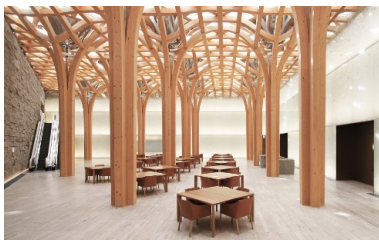

Inside the hall in the Learning Centre

The foyer in front of the Learning Centre auditorium

# More timber structures for Haesley Nine Bridges

Yeosu-gun, KR



Bird's eye view of all buildings

---



View inside a two-bed bedroom in the  
Timber House, Condo A

---

# More timber structures for Haesley Nine Bridges

Yeosu-gun, KR



View inside a suite in the Timber House,  
Condo A