

# New school building in modular timber construction

Dresden, DE



## Project details

Client	Schulverwaltungsamt Landeshauptstadt Dresden
Architecture	Peter Zirkel Ges. v. Architekten
Project type	Education and research
Construction type	Modular construction, Wood element construction
Services	General contractor services (GC)
Construction	2021-2022
Locality	Dresden, Seidnitz
Country	Germany

## Green modular structure for the school on Schilfweg

On the grounds of the former adult education centre on Schilfweg, a flexible new school building in a prefabricated design provides space for primary and secondary school classes as required. Blumer Lehmann was responsible for the modular timber structure as GC and produced the 112 room modules in its factory in Grossenlöder.

Dresden-based architectural firm Peter Zirkel designed the new three-storey school building as a modular timber hybrid structure. The 112 room modules were produced in the Blumer Lehmann modular construction factory in Grossenlöder, near Fulda. The timber modules are combined with classic prefabricated timber components to form two three-storey school structures that join the sports hall to form a group around an entrance courtyard.

The decision-makers deliberately opted for timber to build with because of its carbon storage capacity. Together with a green roof and timber facade partly covered in trellises for climbing plants, the building helps improve urban climatic conditions in the district. Building with prefabricated timber modules also kept construction time to a minimum. Each classroom is formed of three timber modules measuring 2.9 x 8 m.

## Specific Contact



### Alexander Holl

Head of Sales | Planning | Timber and  
Modular Construction | Germany  
Grafschaft Location Manager

T +49 2225 91130 - 10  
[alexander.holl@blumer-lehmann.com](mailto:alexander.holl@blumer-lehmann.com)

# New school building in modular timber construction

Dresden, DE



The new school building made of wooden modules also houses a spacious canteen.



Wood was also used for the facade of the modular school building.

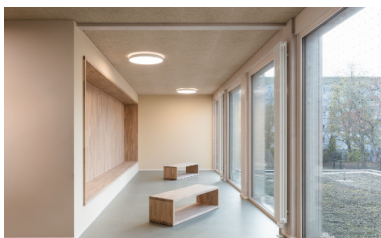

The school replacement building offers flexible and learning-friendly school space for the school children and teachers.

Each 3 wooden modules with an area of 2.9 x 8 m form a classroom.

# New school building in modular timber construction

Dresden, DE



Workroom of the Schilfweg School  
Dresden



The 112 room modules in total were  
produced in our factory in Grossenlöder.