

# Modular build with canteen for Osterath school

Köln, DE



## Project details

Client	Gebäudewirtschaft der Stadt Köln
Architecture	Jankowski Bürgener Architekten Stadtplaner
Project type	Education and research
Construction type	Modular construction
Services	JC
Construction	2023
Locality	Köln
Country	Germany

## Comfortable rooms for lessons and all-day care

Blumer Lehmann is the FSC responsible for delivering the school extension on Osterather Strasse in Cologne. The architectural designs were drawn up by local architectural firm Jankowski Bürgener Architekten Stadtplaner. The City of Cologne chose the modular timber construction due to its swift and sustainable implementation.

The school complex on Osterather Strasse consists of a listed main building dating from 1903 and partially dilapidated adjacent buildings. The modular timber construction of the extension provides pupils and teaching staff with comfortable and high-quality rooms for classes and full-day care as well as a canteen with 150 seats and a school kitchen. There is plenty of timber visible on the inside and the facade design to ensure comfortable indoor conditions.

The two-storey modular timber construction with 1,700 m<sup>2</sup> of usable space meets the 'Passivhaus' energy standard and is equipped with a photovoltaic system and a green roof. The building is designed as a linear rectangle measuring 66 m in length and 14.5 m in width.

## Specific Contact



**Alexander Holl**

Division Manager Timber and Modular  
Construction | Germany  
Grafschaft Location Manager

T +49 2225 91130-10

[alexander.holl@blumer-lehmann.com](mailto:alexander.holl@blumer-lehmann.com)

# Modular build with canteen for Osterath school

Köln, DE



The bright classroom shows how timber construction creates a warm, functional and high-quality learning environment.



The open seating niche combines quality of stay, daylight and visible wood surfaces in a welcoming school environment.

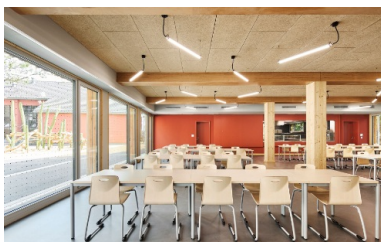

The spacious common room highlights the warm atmosphere and functional quality of the modular school building.